

String Encoder

Mates To Virtually Any Encoder
 Ranges: 0-600 to 0-1700 inches
 Available With or Without Encoder

<Extended Range>

PT9600

Specification Summary:

GENERAL

Full Stroke Range Options—on this datasheet 0-600 to 0-1700 inches
 Motion Conversion Ratio 12.6 inches per turn, see ordering information
 Accuracy
 Typical the lesser of 0.02% f.s. or 0.04% of measurement ±1/2 pulse max.
 Best not less than 0.001 in. (0.03 mm)
 Repeatability ±0.02% of measurement ±1/2 pulse max.
 Measuring Cable nylon-coated stainless steel
 Enclosure Material powder-painted aluminum
 Encoder Shaft Coupling aluminum flexible coupling
 Maximum Allowable Rotational Sensor Torque 1.0 in-lbs.
 Maximum Retraction Acceleration see ordering information
 Maximum Velocity see ordering information
 Weight, Aluminum (Stainless Steel) Enclosure 14 lbs. (28 lbs.) max.

ENVIRONMENTAL

Operating Temperature -40° to 200°F (-40° to 90°C)



Our unique string encoder module mates to virtually any encoder, giving you a cost-effective long-range linear position measurement solution that precisely fits your requirements.

This modular approach delivers the ultimate in flexibility. To order, simply select the measurement range, the cable tension and encoder mounting style—it's that easy! We even supply all the necessary encoder mounting tools and attaching hardware. If you can't find your encoder mounting style or you want us to provide the encoder, please give us a call.



Ordering Information:

Model Number:

PT9600- _____ **1** _____
 order code: **R** **A** **B** **C** **D**

Sample Model Number:

PT9600 - 1500 - 111 - F01

- R** range: 1500 inches
- A** enclosure: aluminum
- C** cable exit: front
- D** rotational sensor mounting style: F01 (2.5-in. sq. flange)

» Trying to reorder but can't find your existing model number? Please contact factory for help.

Full Stroke Range/Conversion Ratio:

R order code:	0600	0800	1000	1200	1500	1700
full stroke range, min:	600 in.	800 in.	1000 in.	1200 in.	1500 in.	1700 in.
cable tension (±35%):	27 oz.	24 oz.	20 oz.	19 oz.	18 oz.	17 oz.
measuring cable:	.034-in. dia. nylon-coated stainless	.019-in. dia. nylon-coated stainless	.019-in. dia. nylon-coated stainless	.019-in. dia. nylon-coated stainless	.014-in. dia. nylon-coated stainless	.014-in. dia. nylon-coated stainless
aluminum enclosure, 1 turn =	12.673 ± .010 in.	12.626 ± .010 in.	12.626 ± .010 in.	12.626 ± .010 in.	12.613 ± .010 in.	12.613 ± .010 in.
stainless steel enclosure, 1 turn =	12.579 ± .010 in.	12.532 ± .010 in.	12.532 ± .010 in.	12.532 ± .010 in.	12.519 ± .010 in.	12.519 ± .010 in.

Enclosure Material:

Ⓐ order code:	1	3
enclosure material:	powder-painted aluminum	303 stainless steel
max. acceleration:	1G	.33G
max. velocity:	60 inches/sec.	20 inches/sec.

Cable Exit:

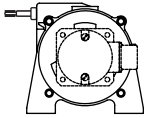
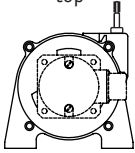
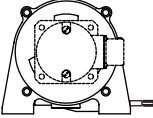
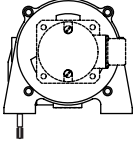
Ⓒ order code:	1	2	3	4
	front	top	back	down
				

Rotational Sensor Mounting Style:

Ⓓ order code:	F01	F02	S01	S02	S04
	2.5-in. Flange Mount 3/8-inch shaft	2-in. Flange Mount 3/8-inch shaft	Face-Mount 6 mm shaft M4 mounting screws	Face-Mount 10 mm shaft M4 mounting screws	Face-Mount 10 mm shaft M3 mounting screws

Note: If you don't see your encoder style, please contact factory. All encoder types supported.

F01 - 2½-inch Sq. Flange Mount (3/8-inch shaft)

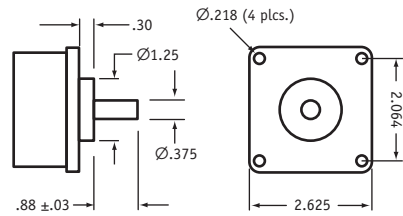

all dimensions are in inches

S01 - Face-Mount (6mm shaft/M4 screws)

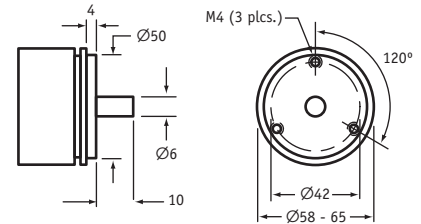

all dimensions are in mm

F02 - 2-inch Sq. Flange Mount (3/8-inch shaft)

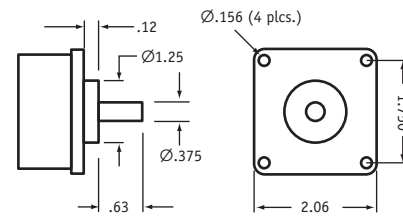

all dimensions are in inches

S02 - Face-Mount (10mm shaft/M4 screws)

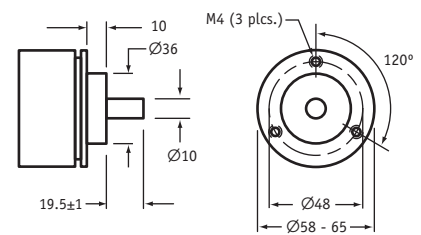

all dimensions are in mm

S04 - Face-Mount (10mm shaft/M3 screws)

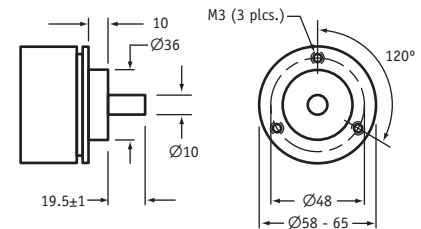

all dimensions are in mm

PT9600 • Extended Range • Cable Reel Mates To Virtually Any Encoder

Outline Drawing

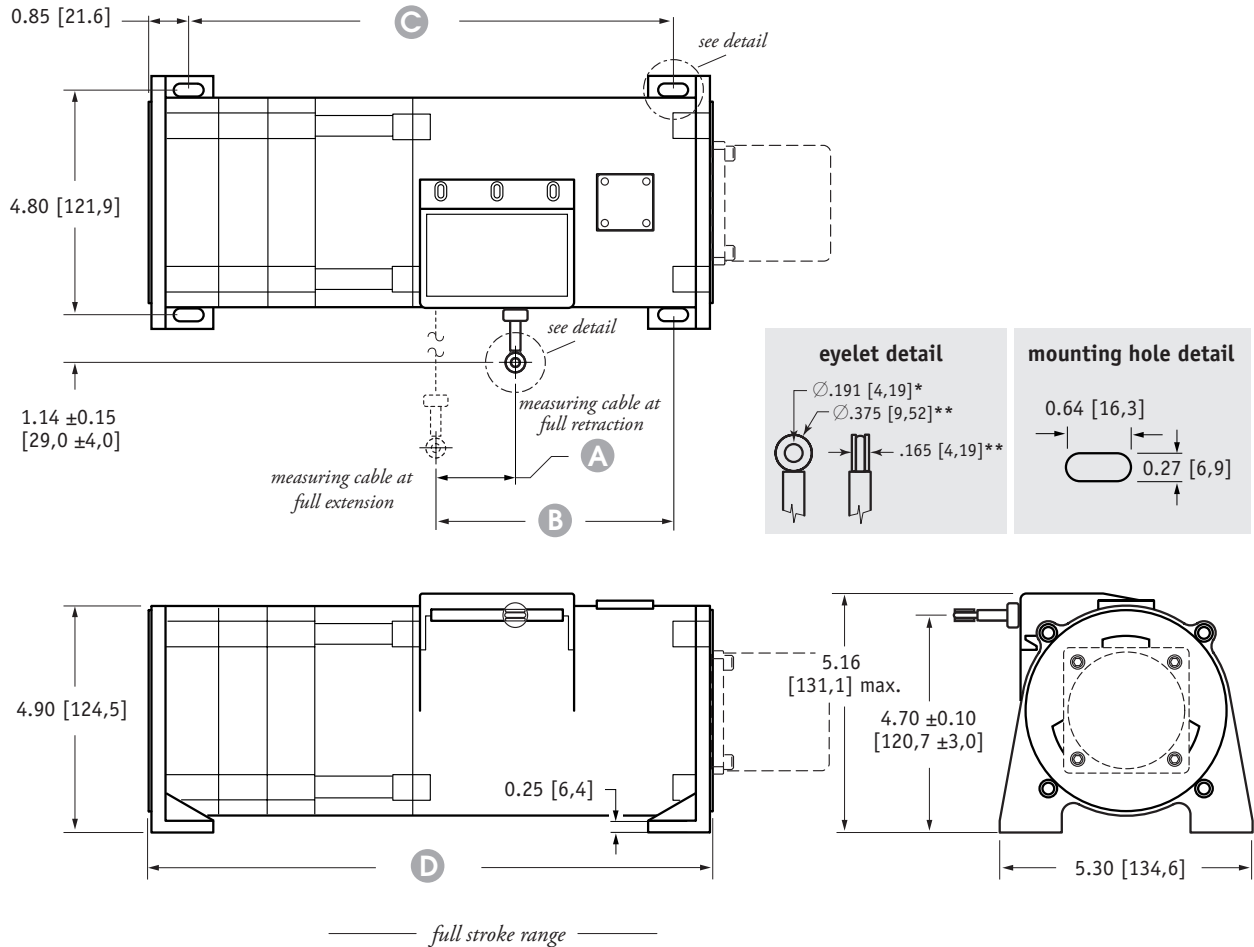

	600 in.	800 in.	1000 in.	1200 in.	1500 in.	1700 in.
A	1.76 [44,7]	1.58 [40,1]	1.98 [50,2]	1.49 [37,8]	1.86 [47,2]	2.11 [53,6]
B	4.52 ±0.15 [114,8 ±4,0]					
C	10.40 ±0.08 [264,2 ±2,0]					
D	12.15 [308,6] max.					

DIMENSIONS ARE IN INCHES [MM]
tolerances are 0.03 IN. [0.5 MM] unless otherwise noted.

* tolerance = +.005 - .001 [+ .13 - .03]
** tolerance = +.005 - .005 [+ .13 - .13]

version: 4.0 last updated: September 6, 2011
PT9600 Extended Range | 196